

## FOR IMMEDIATE RELEASE

### Unlocking Global Success—TriMark's 050-1900

**New Hampton, IA—December, 2016**—TriMark has acquired a global reputation for providing innovative access solutions for a variety of demanding customers. "Turn-key" solutions are achieved because we have dedicated teams of engineers capable of rapidly responding to your needs with hardware knowledge and expertise.

#### **Challenges Met and Accepted – How TriMark Is Raising the Bar for Rotary Latches**

A couple of years ago a major customer challenged TriMark to develop a new rotary door latch as part of a new design for their entrance doors and door hold-backs. As a result, Tri initiated a new product development program with the goal of designing and developing a new product: "Next Generation Rotary Latch".

#### **Modular Concept for a Global Market**

TriMark proposed a modular concept based on the best features from our extensive portfolio of rotary latching products. This concept allows for application flexibility utilizing TriMark's expansive trip lever options, exterior handles, linkage rods and inside releases. Its modular case construction is preconfigured with multiple actuation points on the front case allowing top/bottom actuation including stacked actuators as well as combinations of actuation points, which provide the most configurable rotary door latch ever engineered. In addition the platform was designed to reuse TriMark's extensive selections of existing actuators reducing application engineering and unnecessary tooling requirements.

TriMark recognizes that modular products enable faster, easier and more efficient customization of standard products to unique customer needs— with reduced lead-time and engineering support.

#### **Flexibility**

TriMark's newest innovation in rotary latches features a robust modular design that offers extensive actuation locations and options providing application flexibility in a compact design. Designed for medium to heavy-duty applications for on or off-highway applications, this single rotor latch is available in both FMVSS 206 and non FMVSS 206 configurations.

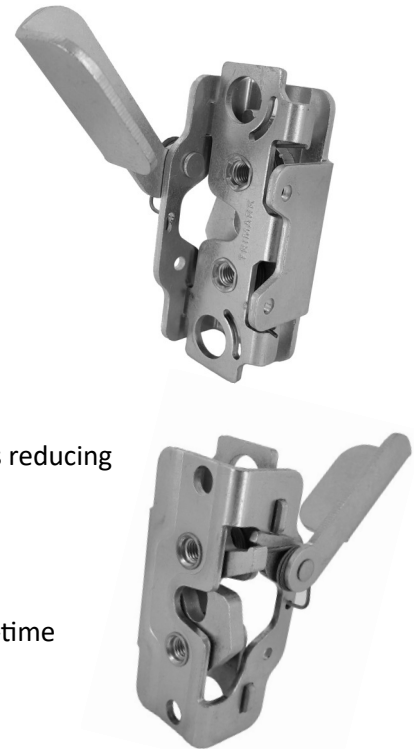

The 'base' latch is designed using all non-handed components allowing left/right hand assemblies by orienting the internal latch components in the proper orientation. Additionally, this product is available in single or 2 position rotor configuration plus the single rotor provides for vertical clearance of strike allowing for door sag, misalignment and ease of installation.

**Global Focus**

Today's Global operator stations demand ergonomic hardware placement as well as functional positioning of the latch, inside release and exterior handle into door structures. In addition increasingly larger glass areas challenge the door designers for space claims, connectivity and ease of installation and

adjustment. This new latch platform's compact size and shape allows maximum use of door space and minimizes visibility issues without compromising strength or robustness. Its innovative barrel release with optional integrated cable bracket for ease of use/installation excels on agricultural and construction applications with massive glass doors coupled with weather tight door seals which demand low operating efforts.

Modular construction with multiple actuation points allows top/bottom actuation including stacked actuators as well as combinations of actuation points.

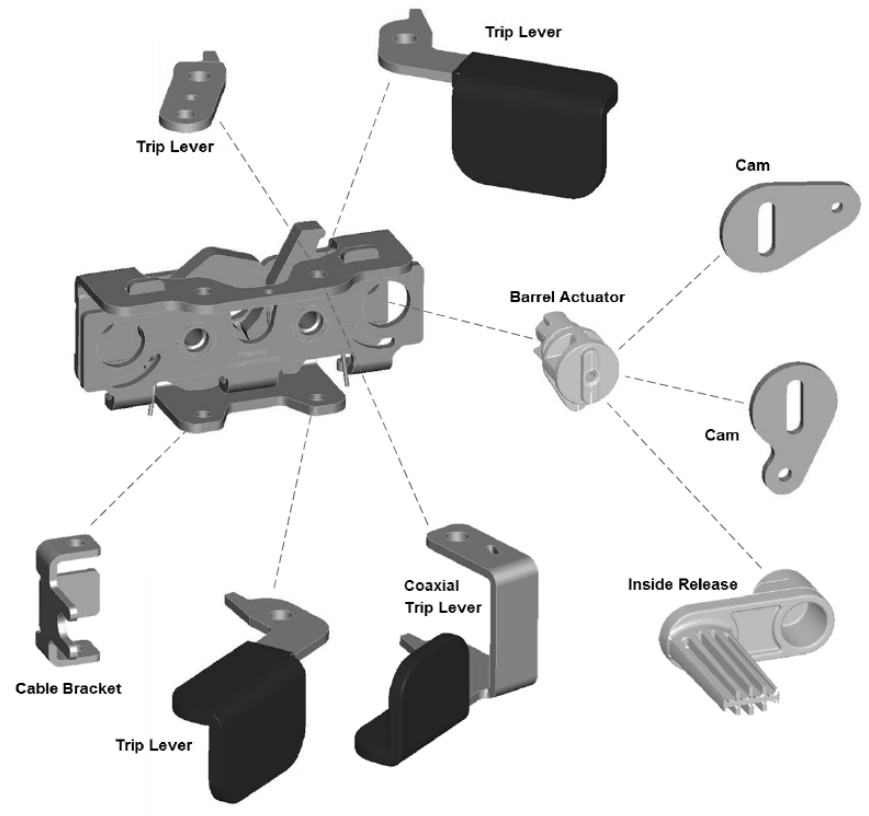

**Barrel Actuation With Direct Release Cam and Top Inside Release Actuator**



**Cable Mount Bracket With Barrel Actuation and Cam**

Varied applications for Global Ag and Construction demand application versatility with considerations for remote release utilizing rods or cable connections, direct release from external handle, on-latch inside release levers with robust pivots, multiple release levers, left and right hand versions and a small footprint to allow for maximum visibility. This product platform delivers on all points in a single latch family.

Safety was not overlooked either; the Latch demonstrates Industry leading strength, providing a robust structural element and the 8mm diameter automotive style hoop-type striker minimizes clothing snag hazard.



070-1000 8mm Hoop Strike



Several actuator return spring options plus optional coaxial actuator mechanisms are available for applications where it is desirable to provide additional support to the actuation levers.

In addition, accessories such as striker bolts, cage nuts, cables, rods and clips are available. System kits are also available and include handles, brackets and power lock actuators to provide a comprehensive electro-mechanical access solution.

Future provisions are also planned for state-sensing, power release mechanisms and an innovative slam cam door lift mechanism for heavy doors that are prone to sagging. *TriMark's* expertise in system integration has evolved into a system category called Mechatronics, which combines mechanical and electrical elements. Not only is this approach elegant and efficient, it lowers the combined cost for products and simplifies installation mounting and wiring for the OEM installation. Truly another example of smart design that solves problems and reduces cost while enabling increased functionality.

*TriMark* Corporation is an employee-owned company and is a recognized leader in the design and manufacture of quality vehicle hardware products for the mass transit/bus, recreational vehicle, agricultural, truck, construction, and enclosure markets. We offer a comprehensive selection of handles, latches, linkages, hinges, and complete door access systems that includes mechatronic solutions for keyless entry, vehicle security and ignition control. *TriMark* corporate headquarters is located in New Hampton, Iowa, USA and serves the European market through its subsidiary, *TriMark* Europe Ltd, based at Bardon Hill, near Coalville, Leicester and the China market through *TriMark* Xuzhou.